

CARIBBEAN II



3,546 SQ. FT.	4 BEDROOM+STUDY & BONUS, 4 BATH, 3-CAR GARAGE
---------------	---

Floor plans and elevations are artist's concepts and may vary in precise detail from the plans and specifications. LifeStyle Homes reserves the right to change prices, plans, features, dimensions and specifications without notice. Elevations and floor plans are subject to Homeowner Association (HOA) restrictions. Subject to errors, omissions, deletions and availability. CBC023179



CARIBBEAN II

72' width x 51'x2" depth

SINCE 1984
LifeStyle
solar-powered
H O M E S

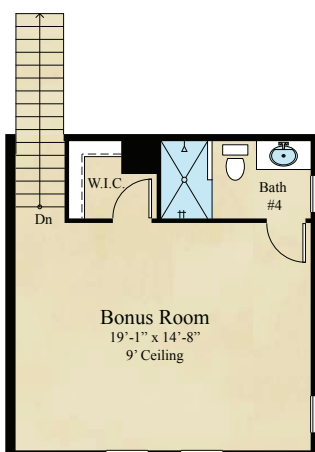

SQUARE FOOTAGE

FIRST FLOOR 2,129

SECOND FLOOR..... 402

GARAGE 751

COVERED PORCH 225

ENTRY 39

TOTAL SQ. FT. 3,546



3,546 SQ. FT.

4 BEDROOM+STUDY & BONUS, 4 BATH, 3-CAR GARAGE

Floor plans and elevations are artist's concepts and may vary in precise detail from the plans and specifications. LifeStyle Homes reserves the right to change prices, plans, features, dimensions and specifications without notice. Elevations and floor plans are subject to Homeowner Association (HOA) restrictions. Subject to errors, omissions, deletions and availability. CBC023179

